

Simple Kids desk

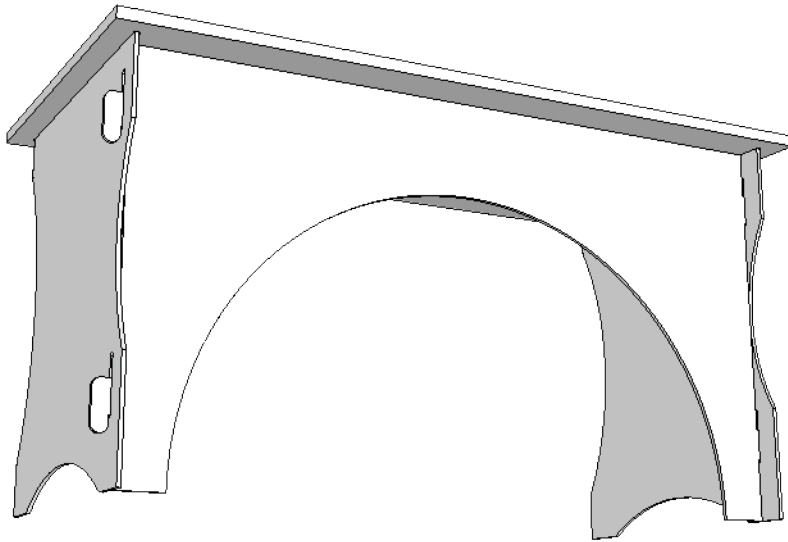

plans provided by
Homewood Creations
social@homewoodcreations.com

Note: this is designed to be simple to manufacture,
all parts can be cut by a 3/8 bit. We use a 3/8 compression bit
(onsrud 60-123mc), at 21,000 rpm and 24 m/min it requires about
2.5 min of cnc time

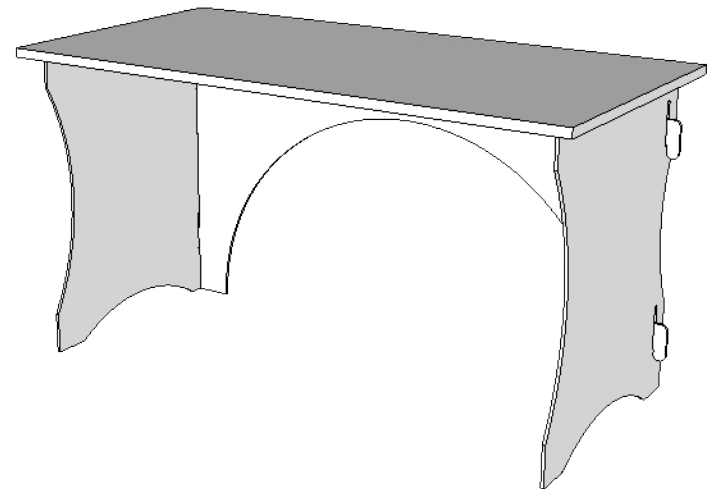

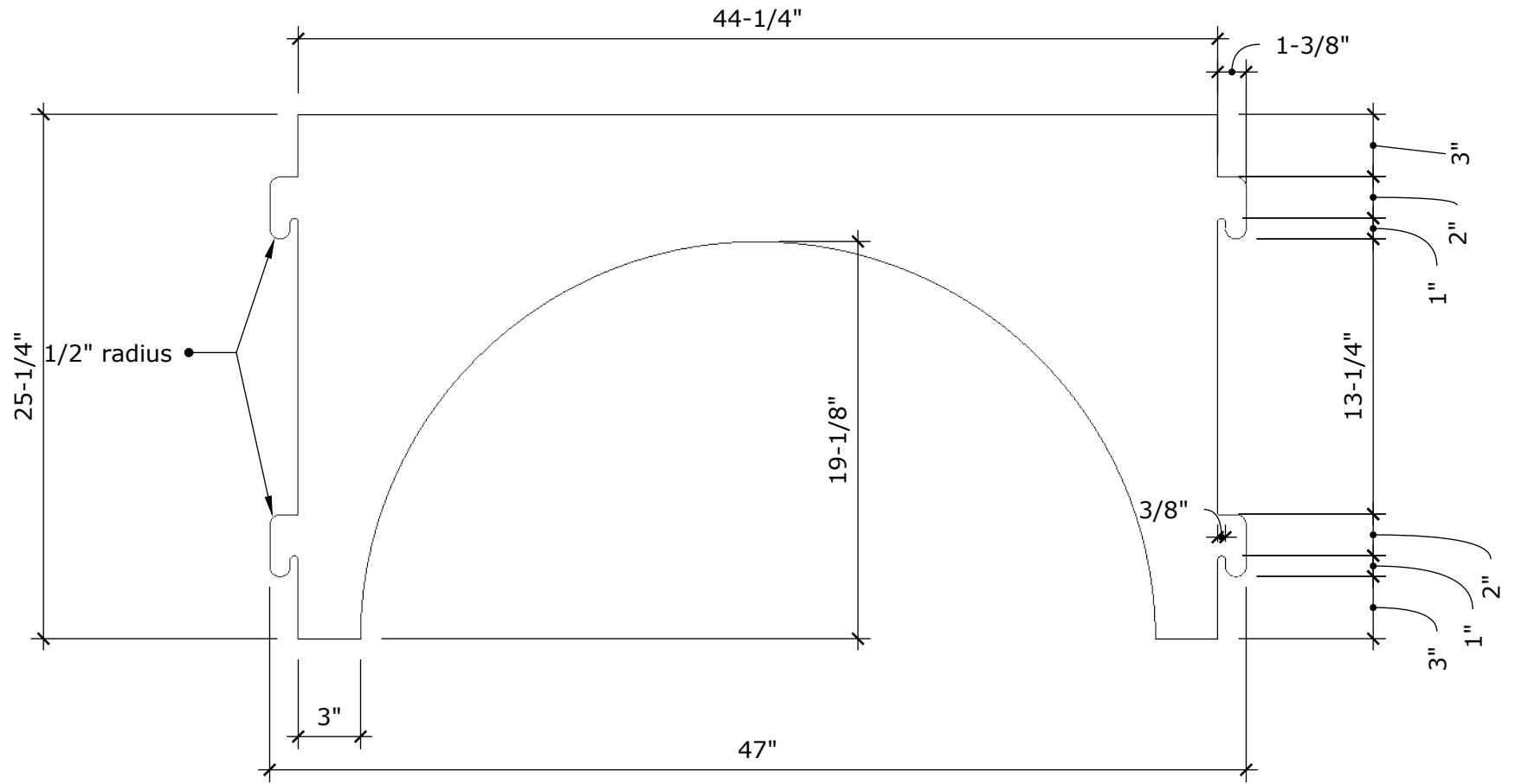

Back
 1/4 mdf

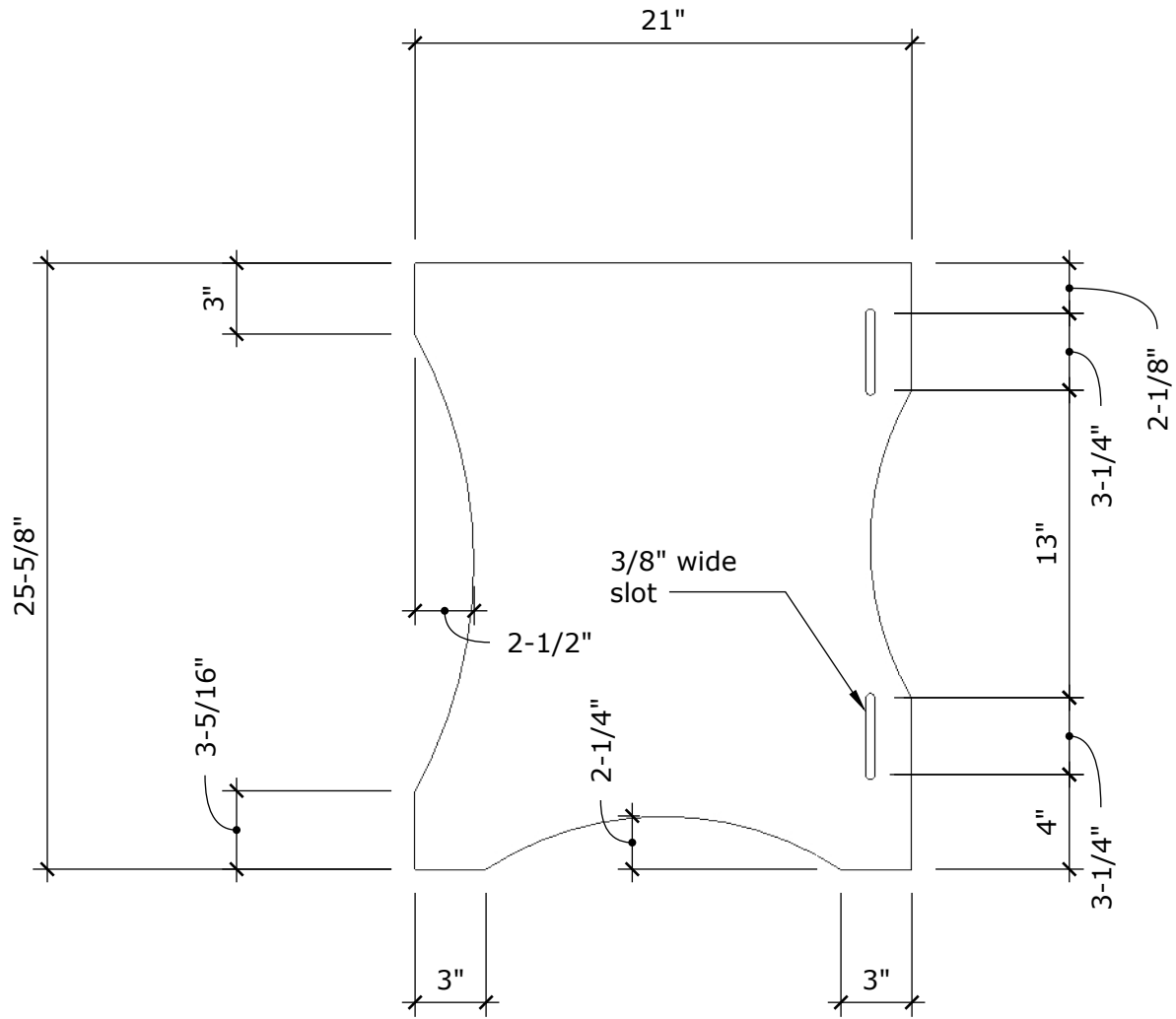

Sides

1/4" mdf - 2 required

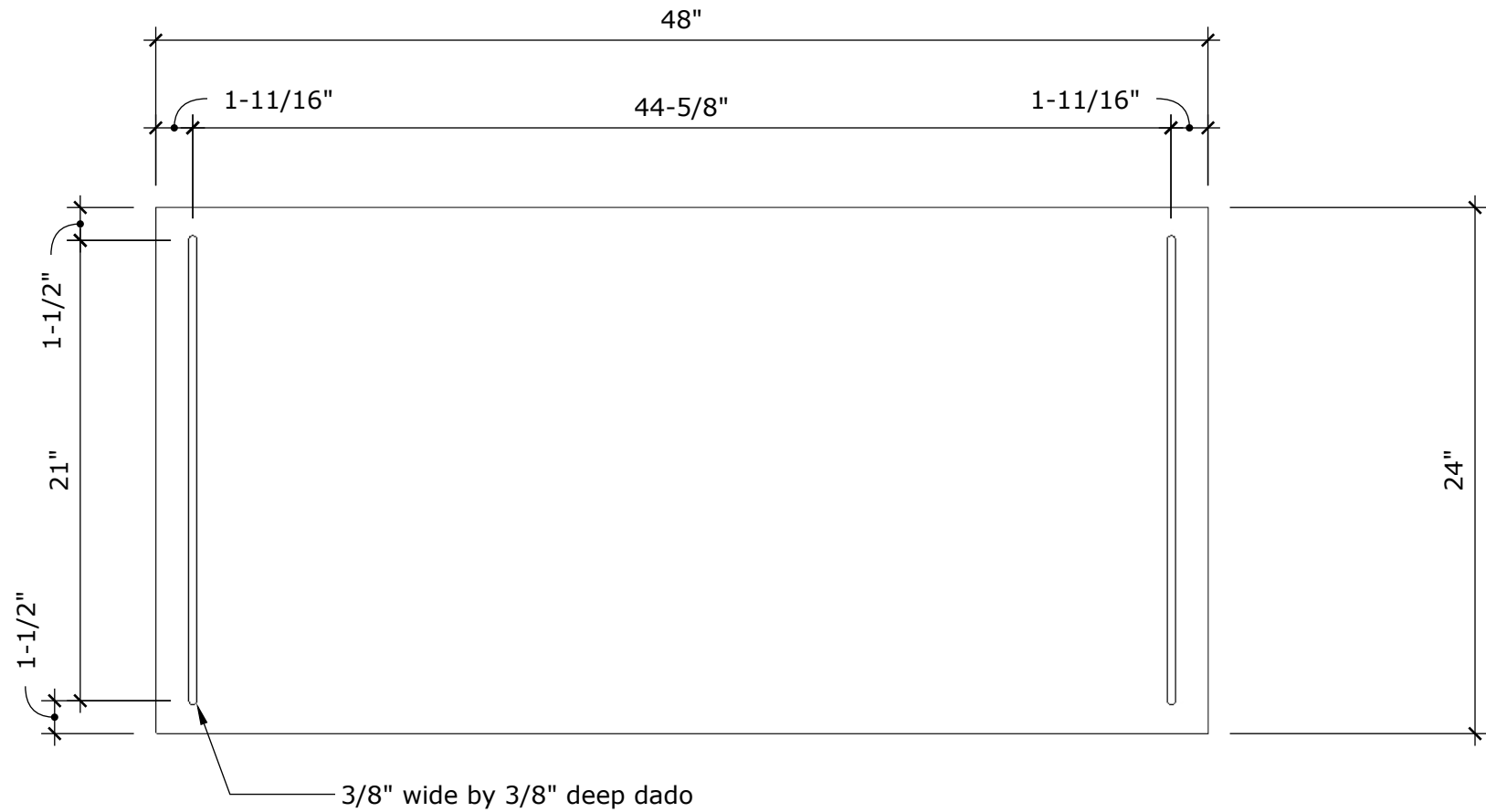

note:
 overall dimension can be smaller
 to accommodate smaller sheet sizes,
 maintain dado length and spacing

Table Top

3/4" 2 sided melamine or
 equivalent (this should be a
 material that can be sanitized)
 edgebanded all 4 sides